

# **SHARPE<sup>®</sup> VALVES**

---

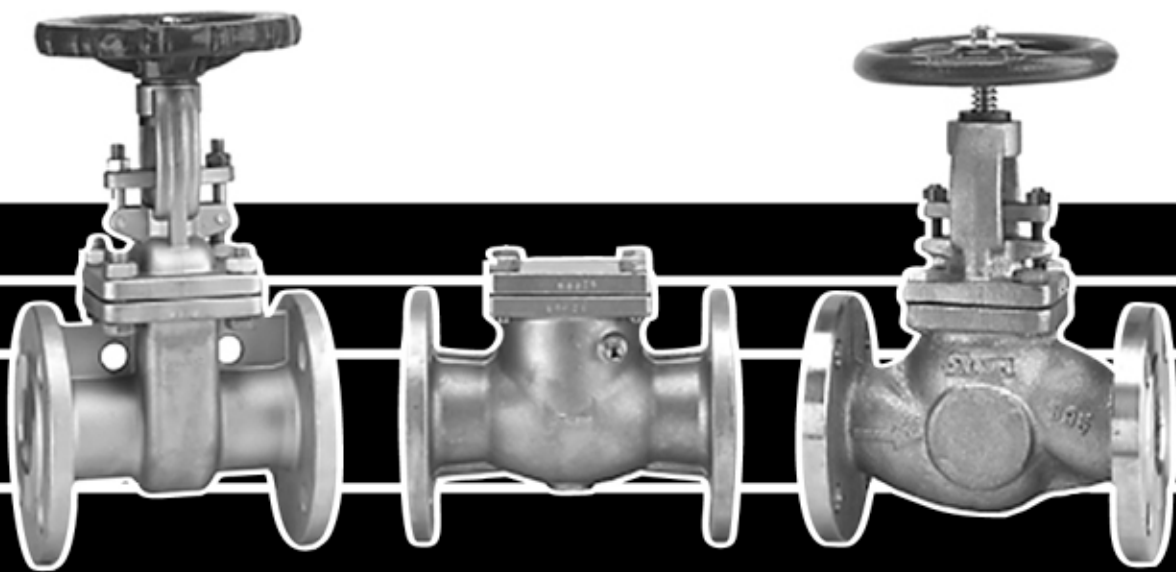

**FLANGED GATE, GLOBE  
AND CHECK VALVES**

# SHARPE VALVES

## SERIES 35 STAINLESS STEEL 150# FLANGED GATE

### DESIGN DESCRIPTION:

- OUTSIDE SCREW AND YOKE
- BOLTED BONNET
- FLEXIBLE WEDGE, FULLY GUIDED
- INTEGRAL SEATS
- RISING STEM AND NON-RISING HANDWHEEL
- AVAILABLE WITH GEAR OPERATOR
- FLANGED ENDS
- BUTTWELDING ENDS

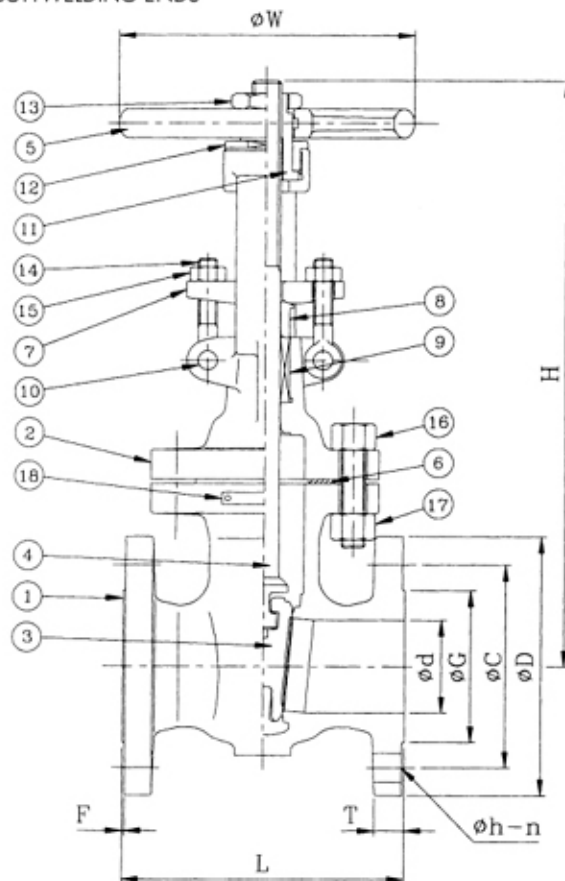

### DIMENSION TABLE:

Size	Ød	L	L1	H <sub>(OPEN)</sub>	ØW	T	F	ØD	ØC	ØG	Øh	n	WT.(lbs.)
1/2	0.5	4.25	4.25	7.50	3.50	0.44	0.06	3.51	2.38	1.38	6.3	4	6.60
3/4	0.75	4.60	4.60	7.90	3.50	0.44	0.06	3.88	2.75	1.70	6.3	4	7.70
1	1	5.00	5.00	9.00	4.00	0.44	0.06	4.25	3.18	2.00	6.3	4	10.50
1 1/2	1.5	6.50	6.50	11.00	5.50	0.56	0.06	5.00	3.88	2.88	6.3	4	17.50
2	2	7.00	8.50	12.60	6.30	0.62	0.06	6.00	4.75	3.62	0.75	4	26.50
2 1/2	2.5	7.50	9.50	15.40	7.10	0.69	0.06	7.00	5.50	4.12	0.75	4	42.00
3	3	8.00	11.00	16.40	7.90	0.75	0.06	7.50	6.00	5.00	0.75	4	46.50
4	4	9.00	12.00	20.00	8.86	0.94	0.06	9.00	7.50	6.18	0.75	8	73.00
6	6	10.50	15.87	28.00	11.45	1.00	0.06	11.00	9.50	8.50	0.87	8	128
8	8	11.50	16.50	35.50	13.00	1.12	0.06	13.50	11.75	10.62	0.87	8	187
10	10	13.00	18.00	44.00	13.80	1.18	0.06	16.00	14.25	12.75	1.00	12	297
12	12	14.00	19.75	52.00	15.80	1.25	0.06	19.00	17.00	15.00	1.00	12	462
14	13.25	15.00	22.50	58.25	21.70	1.38	0.06	21.00	18.75	16.25	1.12	12	634
16	15.25	16.00	24.00	62.30	23.70	1.44	0.06	23.50	21.25	18.50	1.12	16	946
18	17.25	17.00	26.00	77.30	21.65	1.56	0.06	25.00	22.75	21.00	1.25	16	1378
20	19.25	18.00	28.00	83.90	23.70	1.70	0.06	27.50	25.00	23.00	1.25	20	1844
24	23.25	20.00	32.00	101.00	27.60	1.88	0.06	32.00	29.50	27.25	1.38	20	2464

Due to continuous development of our product range we reserve the right to change the dimensions and information contained in the leaflet as required.

### APPLICABLE STANDARDS:

- GATE VALVES, API 603
- STEEL VALVES, ANSI B16.34
- FACE TO FACE, ANSI B16.10
- END FLANGES, ANSI B16.5
- BUTTWELDING ENDS, ANSI B16.25
- INSPECTION AND TEST, API 598

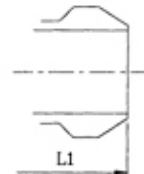

Buttwelding Ends

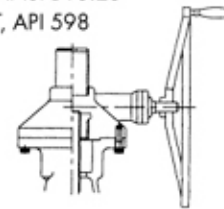

Available With Gear Operator

### PARTS AND MATERIAL (ASTM)

NO.	PARTS NAME	MATERIALS
		CF8M
1	Body	A351 - CF8M
2	Bonnet	A351 - CF8M
3	Disc	A351 - CF8M
4	Stem	A182 - F316
5	Hand Wheel	A47 / A536
6	Gasket	PTFE / Grafoil + 316 Sheet
7	Gland flange	A351 - CF8
8	Gland	A351 - CF8M
9	Gland packing	PTFE / Graphite
10	Eye Bolt Pin	A276 - 304
11	Stem Nut	A439 - D2 / Bronze
12	Retainer Nut	A351 - CF8
13	Wheel Nut	B16
14	Eye Bolt	A193 - B8
15	Eye Bolt Nut	A194 - 8
16	Bonnet Bolt	A193 - B8
17	Bonnet Bolt Nut	A194 - 8
18	Name Plate	A666 - 304

OTHER MATERIALS ARE AVAILABLE UPON REQUEST.

### TEST PRESSURE TO API 598

SHELL TEST (water)	SEAT TEST (water)	SEAT TEST (air)
450	314	80

PSIG

# SHARPE VALVES

## SERIES 35 STAINLESS STEEL 300# FLANGED GATE

### DESIGN DESCRIPTION:

- OUTSIDE SCREW AND YOKE
- BOLTED BONNET
- FLEXIBLE WEDGE, FULLY GUIDED
- INTEGRAL SEATS
- RISING STEM AND NON-RISING HANDWHEEL
- AVAILABLE WITH GEAR OPERATOR
- FLANGED ENDS
- BUTTWELDING ENDS

### APPLICABLE STANDARDS:

- STEEL VALVES, ANSI B16.34
- FACE TO FACE, ANSI B16.10
- END FLANGES, ANSI B16.5
- BUTTWELDING ENDS, ANSI B16.25
- INSPECTION AND TEST, API 598

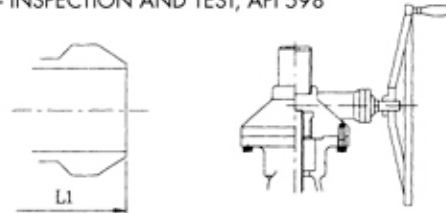
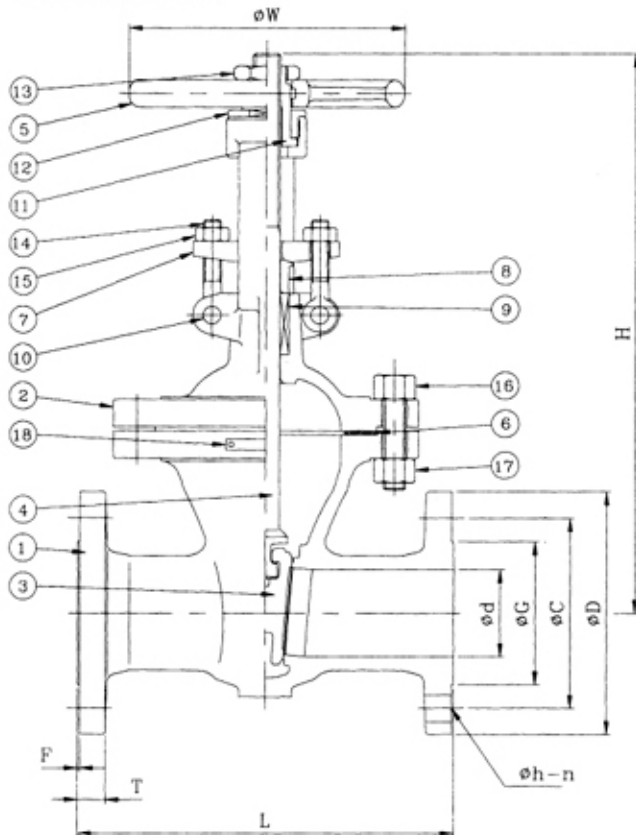

Buttwelding Ends Available With Gear Operator

### PARTS AND MATERIAL (ASTM)

NO.	PARTS NAME	MATERIALS
		CF8M
1	Body	A351 - CF8M
2	Bonnet	A351 - CF8M
3	Disc	A351 - CF8M
4	Stem	A182 - F316
5	Hand Wheel	A47 / A536
6	Gasket	316 Spiralwound
7	Gland flange	A351 - CF8
8	Gland	A351 - CF8M
9	Gland packing	PTFE / Graphite
10	Eye Bolt Pin	A276 - 304
11	Stem Nut	A439 - D2 / Bronze
12	Retainer Nut	A351 - CF8
13	Wheel Nut	B16
14	Eye Bolt	A193 - B8
15	Eye Bolt Nut	A194 - 8
16	Bonnet Bolt	A193 - B8
17	Bonnet Bolt Nut	A194 - 8
18	Name Plate	A666 - 304

OTHER MATERIALS ARE AVAILABLE UPON REQUEST.

### TEST PRESSURE TO API 598

PSIG

SHELL TEST (water)	SEAT TEST (water)	SEAT TEST (air)
1125	814	80

### DIMENSION TABLE:

Size	Ød	L	L1	H <sub>(OPEN)</sub>	ØW	T	F	ØD	ØC	ØG	Øh	n	WT.(lbs.)
1/2	0.50	5.50	5.50	6.30	4.00	0.56	0.06	3.75	2.62	1.38	0.62	4	13.20
3/4	0.75	6.00	6.00	7.10	4.75	0.62	0.06	4.63	3.25	1.70	0.75	4	18.00
1	1.00	6.50	6.50	8.30	5.50	0.68	0.06	4.88	3.50	2.00	0.75	4	22.00
1 1/2	1.50	7.50	7.50	11.00	6.30	0.82	0.06	6.12	4.50	2.88	0.88	4	33
2	2.00	8.50	8.50	13.00	7.10	0.88	0.06	6.50	5.00	3.63	0.88	8	41
2 1/2	2.50	9.50	9.50	15.50	7.90	1.00	0.06	7.50	5.88	4.13	0.88	8	55
3	3.00	11.15	11.15	17.90	8.85	1.12	0.06	8.25	6.60	5.00	0.88	8	83
4	4.00	12.00	12.00	21.00	9.85	1.25	0.06	10.00	7.88	6.19	0.88	8	127
6	6.00	15.90	15.90	29.00	11.85	1.44	0.06	12.50	10.62	8.50	0.88	12	231
8	8.00	16.50	16.50	36.75	13.80	1.62	0.06	14.50	13.00	10.62	1.00	12	380
10	10.00	18.00	18.00	45.00	15.75	1.88	0.06	17.50	15.25	12.75	1.12	16	616
12	12.00	19.75	19.75	53.00	19.70	2.00	0.06	20.50	17.75	14.50	1.25	16	831
14	13.25	30.00	30.00	72.00	24.00	2.12	0.06	23.00	20.25	16.25	1.25	20	1561
16	15.25	33.00	33.00	80.00	27.60	2.25	0.06	25.50	22.50	18.50	1.38	20	2284
18	17.25	36.00	36.00	87.00	31.50	2.38	0.06	28.00	24.75	21.00	1.38	24	2700
20	19.25	39.00	39.00	99.00	35.50	2.50	0.06	30.50	27.00	23.00	1.38	24	3608
24	23.25	45.00	45.00	114.00	39.40	2.75	0.06	36.00	32.00	27.25	1.61	24	5070

Due to continuous development of our product range we reserve the right to change the dimensions and information contained in the leaflet as required.

# SHARPE VALVES

## SERIES 35 CAST STEEL 150# FLANGED GATE

### DESIGN DESCRIPTION:

- OUTSIDE SCREW AND YOKE
- BOLTED BONNET
- STEM/WEDGE CONNECTION MEETS THE API 600 PULL TEST
- FLEXIBLE WEDGE, FULLY GUIDED
- WELDED SEAT
- RENEWABLE SEAT RINGS
- RISING STEM AND NON-RISING HANDWHEEL
- AVAILABLE WITH GEAR OPERATOR
- FLANGED ENDS
- BUTTWELDING ENDS

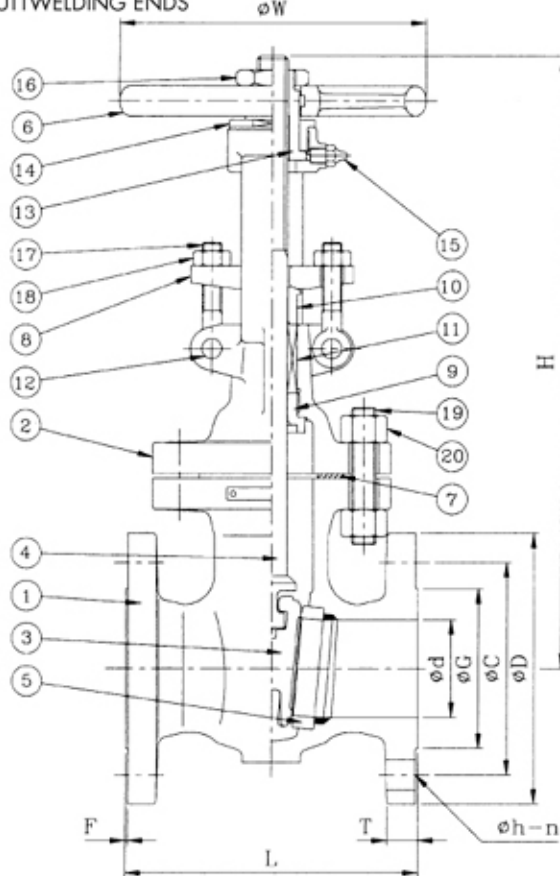

### DIMENSION TABLE:

Size	Ød	L	L1	H	H(OPEN)	ØW	T	F	ØD	ØC	ØG	Øh	n	WT.(lbs.)
2	2	7	8.5	13.50	16	7.88	0.622	0.06	6	4.75	3.62	.75	4	44
2 1/2	2.5	7.5	9.50	16.25	19.38	9.85	0.688	0.06	7	5.5	4.12	.75	4	64
3	3	8	11.10	17.40	20.86	9.85	0.75	0.06	7.5	6	5	.75	4	70
4	4	9	12	19.52	24.10	11.81	0.94	0.06	9	7.5	6.18	.75	8	113
6	6	10.50	15.86	25.20	31.57	13.78	1.00	0.06	11	9.5	8.5	.87	8	190
8	8	11.50	16.50	30.70	39.30	13.78	1.12	0.06	12.8	11.75	10.65	.87	8	286
10	10	13	18	38	48.35	15.75	1.2	0.06	16	14.25	12.75	1	12	476
12	12	14	19.75	44.65	57	17.72	1.25	0.06	19	17	15	1	12	687
14	13.25	15	22.50	54.50	68.70	19.68	1.38	0.06	21	18.75	16.25	1.12	12	979
16	15.25	16	24	63	79.52	23.62	1.44	0.06	23.5	21.25	18.5	1.12	16	1188
18	17.25	17	26	67.50	85.60	27.56	1.56	0.06	24.5	22.75	21	1.25	16	1540
20	19.25	18	28	77.71	97.95	31.50	1.7	0.06	27.5	25	23	1.25	20	1980
24	23.25	20	32	88.50	113.00	35.43	1.88	0.06	32	30	27.25	1.37	20	2465

Due to continuous development of our product range we reserve the right to change the dimensions and information contained in the leaflet as required.

### APPLICABLE STANDARDS:

- GATE VALVES, API 600
- STEEL VALVES, ANSI B16.34
- FACE TO FACE, ANSI B16.10
- END FLANGES, ANSI B16.5
- BUTTWELDING ENDS, ANSI B16.25
- INSPECTION AND TEST, API 598



Buttwelding Ends

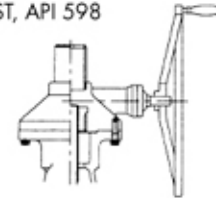

Available With Gear Operator

### PARTS AND MATERIAL (ASTM)

NO.	PARTS NAME	MATERIALS		
		WCB	WC6	LCB
1	Body	A216 - WCB	A217 - WC6	A352 - LCB
2	Bonnet	A216 - WCB	A217 - WC6	A352 - LCB
3	Disc	A216 - WCB + H/F 410	A217 - WC6 + H/F 410	A217 - WC6 + H/F 410
4	Stem	A182 - F6a		
5	Seat	A105 + H/F STL#6	A182 - F11 + H/F STL#6	A350 - WC6 + H/F 410
6	Hand Wheel	A47 / A536		
7	Gasket	Grafoil + 316 Sheet		
8	Gland Flange	A216 - WCB		
9	Bonnet Bush	A276 - 410		
10	Gland	A276 - 410		
11	Gland packing	Graphite		
12	Eye Bolt Pin	A276 - 410		
13	Stem Nut	A439 - D2		
14	Retainer Nut	A36		
15	Nipple	Brass		
16	Wheel Nut	A36		
17	Eye Bolt	A307 B		
18	Eye Bolt Nut	A 194 - 2H		
19	Bonnet Bolt	A193 - B7	A193 - B7	A193 - B7M
20	Bonnet Bolt Nut	A194 - 2H	A194 - 2H	A194 - 2HM
21	Name Plate	A666 - 304		

OTHER MATERIALS ARE AVAILABLE UPON REQUEST.

### TEST PRESSURE TO API 598

PSIG

SHELL TEST (water)	SEAT TEST (water)	SEAT TEST (air)
450	314	80

# SHARPE VALVES

## SERIES 35 CAST STEEL 300# FLANGED GATE

### DESIGN DESCRIPTION:

- OUTSIDE SCREW AND YOKE
- BOLTED BONNET
- STEM/WEDGE CONNECTION MEETS THE API 600 PULL TEST
- FLEXIBLE WEDGE, FULLY GUIDED
- WELDED SEAT
- RENEWABLE SEAT RINGS
- RISING STEM AND NON-RISING HANDWHEEL
- AVAILABLE WITH GEAR OPERATOR
- FLANGED ENDS
- BUTTWELDING ENDS

### APPLICABLE STANDARDS:

- STEEL GATE VALVES, API 600
- STEEL VALVES, ANSI B16.34
- FACE TO FACE, ANSI B16.10
- END FLANGES, ANSI B16.5
- BUTTWELDING ENDS, ANSI B16.25
- INSPECTION AND TEST, API 598

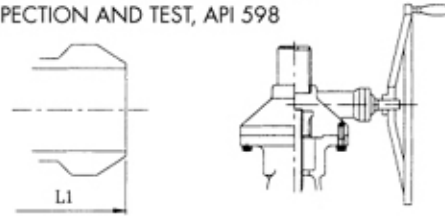

Buttwelding Ends

Available With Gear Operator

### PARTS AND MATERIAL (ASTM)

NO.	PARTS NAME	MATERIALS		
		WCB	WC6	LCB
1	Body	A216 - WCB	A217 - WC6	A352 - LCB
2	Bonnet	A216 - WCB	A217 - WC6	A352 - LCB
3	Disc	A216 - WCB + H/F 410	A217 - WC6 + H/F 410	A352 - LCB + H/F 410
4	Stem	A182 - F6a		
5	Seat	A105 + H/F STL #6	A182 - F11 + H/F STL#6	A350 - IF2 + H/F STL#6
6	Hand Wheel	A47 / A536		
7	Gasket	304 Spiralwound / Grafoil Filler		
8	Gland flange	A216 - WCB		
9	Bonnet Bush	A276 - 410		
10	Gland	A276 - 410		
11	Gland packing	Graphite		
12	Eye Bolt Pin	A276 - 410		
13	Stem Nut	A439 - D2		
14	Retainer Nut	A36		
15	Nipple	Brass		
16	Wheel Nut	A36		
17	Eye Bolt	A307 B		
18	Eye Bolt Nut	A194 - 2H		
19	Bonnet Bolt	A193 - B7	A193 - B7	A193 - B7M
20	Bonnet Bolt Nut	A194 - 2H	A194 - 2H	A194 - 2HM
21	Name Plate	A666 - 304		

OTHER MATERIALS ARE AVAILABLE UPON REQUEST.

### TEST PRESSURE TO API 598

PSIG

SHELL TEST (water)	SEAT TEST (water)	SEAT TEST (air)
1125	814	80

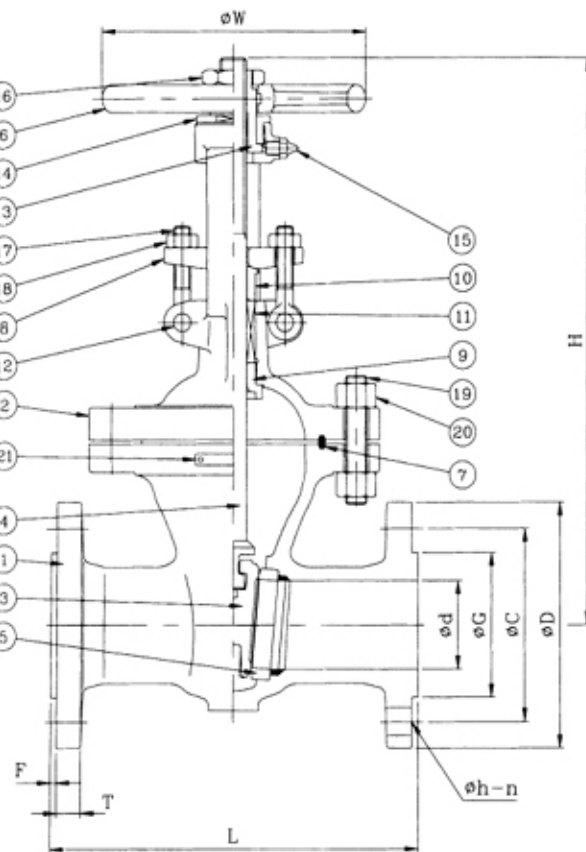

### DIMENSION TABLE:

Size	Ød	L & L1	H	H(OPEN)	ØW	T	F	ØD	ØC	ØG	Øh	n	WT.(lbs.)
2	2	8.50	15.75	18.15	7.87	0.88	0.063	6.50	5	3.63	0.75	8	60
2 1/2	2 1/2	9.50	17.00	20	9.85	1.00	0.063	7.50	5.88	4.13	0.88	8	88
3	3	11.10	18.25	21.65	9.85	1.12	0.063	8.25	6.62	5	0.88	8	104
4	4	12.00	20	24.60	11.81	1.25	0.063	10.00	7.88	6.19	0.88	8	159
6	6	15.86	26.60	33	13.77	1.44	0.063	12.50	10.63	8.5	0.88	12	308
8	8	16.50	32.36	41.06	15.75	1.62	0.063	15	13	10.63	1.00	12	491
10	10	18.00	40.35	50.78	17.72	1.88	0.063	17.50	15.25	12.75	1.13	16	766
12	12	19.75	50	62.51	19.68	2	0.063	20.50	17.75	15	1.25	16	1270
14	13.25	30	57.40	71.65	23.62	2.12	0.063	23	20.25	16.25	1.25	20	1562
16	15.25	33	63.55	80	27.56	2.25	0.063	25.50	22.50	18.50	1.38	20	2284
18	17.25	36	68.42	86.90	31.50	2.38	0.063	28	24.75	21	1.38	24	2700
20	19.25	39	78.35	98.90	35.44	2.50	0.063	30.50	27.00	23	1.38	24	3608
24	23.25	45	89.30	114	39.40	2.75	0.063	36	32	27.25	1.62	24	5065

Due to continuous development of our product range we reserve the right to change the dimensions and information contained in the leaflet as required.

# SHARPE VALVES

## SERIES 35 CAST STEEL 600# FLANGED GATE

### DESIGN DESCRIPTION:

- OUTSIDE SCREW AND YOKE
- BOLTED BONNET
- STEM/WEDGE CONNECTION MEETS THE API 600 PULL TEST
- FLEXIBLE WEDGE, FULLY GUIDED
- WELDED SEAT
- RENEWABLE SEAT RINGS
- RISING STEM AND NON-RISING HANDWHEEL
- AVAILABLE WITH GEAR OPERATOR
- FLANGED ENDS
- BUTTWELDING ENDS

### APPLICABLE STANDARDS:

- STEEL GATE VALVES, API 600
- STEEL VALVES, ANSI B16.34
- FACE TO FACE, ANSI B16.10
- END FLANGES, ANSI B16.5
- BUTTWELDING ENDS, ANSI B16.25
- INSPECTION AND TEST, API 598

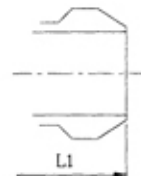
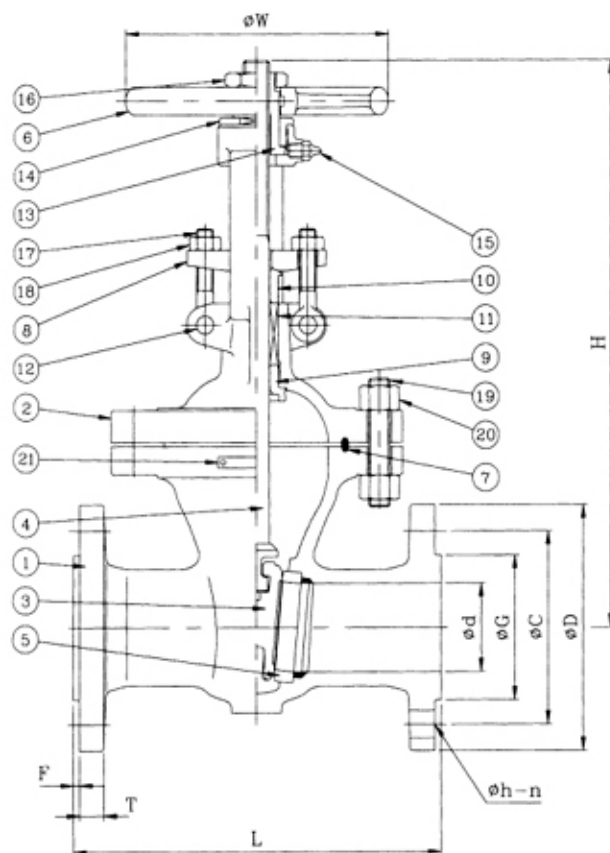

Buttwelding Ends

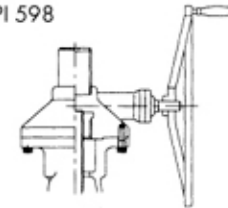

Available With Gear Operator

### PARTS AND MATERIAL (ASTM)

NO.	PARTS NAME	MATERIALS		
		WCB	WC6	LCB
1	Body	A216 - WCB	A217 - WC6	A352 - LCB
2	Bonnet	A216 - WCB	A217 - WC6	A352 - LCB
3	Disc	A216 - WCB + H/F 410	A217 - WC6 + H/F 410	A352 - LCB + H/F 410
4	Stem	A182 - F6a		
5	Seat	A105 + H/F STL#6	A182 - F11 + H/F STL#6	A350 - U2 + H/F STL#6
6	Hand Wheel	A47 / A536		
7	Gasket	Soft - Iron		
8	Gland flange	A216 - WCB		
9	Bonnet Bush	A276 - 410		
10	Gland	A276 - 410		
11	Gland packing	Graphite		
12	Eye Bolt Pin	A276 - 410		
13	Stem Nut	A439 - D2		
14	Retainer Nut	A36		
15	Nipple	Brass		
16	Wheel Nut	A36		
17	Eye Bolt	A193 - B7		
18	Eye Bolt Nut	A194 - 2H		
19	Bonnet Bolt	A193 - B7	A193 - B7	A193 - B7M
20	Bonnet Bolt Nut	A194 - 2H	A194 - 2H	A194 - 2HM
21	Name Plate	A666 - 304		

OTHER MATERIALS ARE AVAILABLE UPON REQUEST.

### TEST PRESSURE TO API 598

PSIG

SHELL TEST (water)	SEAT TEST (water)	SEAT TEST (air)
2225	1628	80

### DIMENSION TABLE:

Size	Ød	L	L1	H	H(OPEN)	ØW	T	F	ØD	ØC	ØG	Øh	n	WT.(lbs.)
2	2	11.50	11.50	14.6	17.35	5.75	1	0.25	6.5	5	3.62	.75	8	82
2 1/2	2.5	13.00	13.00	18.45	21.40	9.85	1.12	0.25	7.5	5.88	4.12	0.88	8	124
3	3	14.00	14.00	18.70	22.40	11.85	1.25	0.25	8.25	6.62	5	0.88	8	168
4	4	17.00	17.00	22	26.65	13.80	1.50	0.25	10.75	8.5	6.18	1	8	300
6	6	22	22	28.30	35.20	17.75	1.88	0.25	14	11.5	8.50	1.12	12	630
8	7.88	25.6	25.6	33.78	42.75	19.70	2.19	0.25	16.50	13.75	10.62	1.25	12	1012
10	9.75	31.00	31.00	39.34	50.30	27.60	2.50	0.25	20	17	12.75	1.38	16	1610
12	11.75	33.00	33.00	46.20	59.25	31.50	2.63	0.25	22	19.25	15	1.38	20	2160
14	12.88	35	35	51.10	65.45	24	2.75	0.25	23.75	20.75	16.25	1.50	20	3036
16	14.75	39	39	57.90	74.20	24	3	0.25	27	23.75	18.50	1.61	20	3385
18	16.50	43	43	62.45	80.50	24	3.25	0.25	29.25	25.75	21	1.75	20	5105
20	18.25	47.25	47.25	68.90	88.50	24	3.75	0.25	32	28.50	25	1.75	24	6013

Due to continuous development of our product range we reserve the right to change the dimensions and information contained in the leaflet as required.

# SHARPE VALVES

## SERIES 45 STAINLESS STEEL 150# FLANGED GLOBE

### DESIGN DESCRIPTION:

- OUTSIDE SCREW AND YOKE
- BOLTED BONNET
- RISING STEM AND HANDWHEEL (IMPACT-HAMMER HANDWHEEL FOR 10" & OVER.)
- YOKE INTEGRAL WITH BONNET
- LOOSE DISC
- INTEGRAL SEAT AND BACK SEAT
- AVAILABLE WITH GEAR OPERATOR
- FLANGED ENDS
- BUTTWELDING ENDS

### APPLICABLE STANDARDS:

- STEEL VALVES, ANSI B16.34
- FACE TO FACE, ANSI B16.10
- END FLANGES, ANSI B16.5
- BUTTWELDING ENDS, ANSI B16.25
- INSPECTION AND TEST, API 598

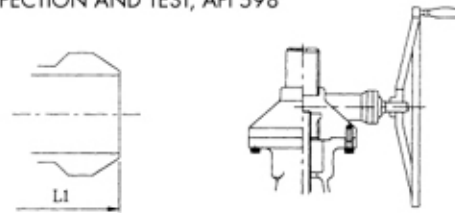

Buttwelding Ends

Available With Gear Operator

### PARTS AND MATERIAL (ASTM)

NO.	PARTS NAME	MATERIALS
		WC6
1	Body	A351 - CF8M
2	Bonnet	A351 - CF8M
3	Disc	A351 - CF8M
4	Stem	A182 - F316
5	Disc Nut	A276 - 316
6	Hand Wheel	A47 / A536
7	Gasket	PTFE / Grafoil + 316 Sheet
8	Gland flange	A351 - CF8
9	Gland	A351 - CF8M
10	Gland packing	PTFE / Graphite
11	Eye Bolt Pin	A276 - 304
12	Stem Nut	A439 - D2 / A276 - 410
13	Washer	A240 - 304
14	Wheel Nut	AISI 304
15	Eye Bolt	A193 - B8
16	Eye Bolt Nut	A194 - 8
17	Bonnet Bolt	A193 - B8
18	Bonnet Bolt Nut	A194 - 8
19	Name Plate	A666 - 304

OTHER MATERIALS ARE AVAILABLE UPON REQUEST.

### TEST PRESSURE TO API 598

PSIG

SHELL TEST (water)	SEAT TEST (water)	SEAT TEST (air)
450	314	80

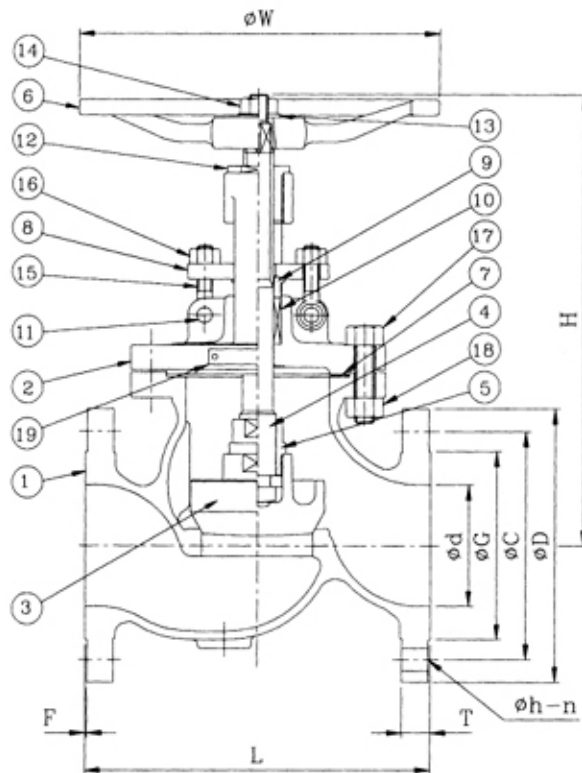

### DIMENSION TABLE:

Size	Ød	L	L1	H(OPEN)	ØW	T	F	ØD	ØC	ØG	Øh	n	WT.(lbs.)
1/2	0.5	4.25	4.25	7.50	3.5	0.44	0.06	3.50	2.38	1.38	0.63	4	6.6
3/4	0.75	4.60	4.60	7.90	4.00	0.44	0.06	3.85	2.75	1.70	0.63	4	8
1	1	5	5	9.00	4.00	0.44	0.06	4.25	3.12	2.00	0.63	4	10.50
1 1/2	1.50	6.50	6.50	9.50	5.50	0.56	0.06	5.00	3.88	2.87	0.63	4	17.50
2	2	8	8	9.85	6.30	0.63	0.06	6.00	4.75	3.62	0.75	4	26.50
2 1/2	2.50	8.50	8.50	10.70	7.10	0.69	0.06	7.00	5.50	4.14	0.75	4	42
3	3	9.50	9.50	11.50	7.90	0.75	0.06	7.50	6.00	5.00	0.75	4	46
4	4	11.50	11.50	13.80	8.90	0.95	0.06	9.00	7.50	6.20	0.75	8	73
6	6	16	16	20.50	11.85	1.00	0.06	11.00	9.50	8.50	0.88	8	135
8	8	19.50	19.50	22.50	13.80	1.12	0.06	13.50	11.75	10.63	0.88	8	254
10	10	24.50	24.50	26.40	15.75	1.18	0.06	16.00	14.25	12.75	1.00	12	375
12	12	27.50	27.50	29.00	20.00	1.25	0.06	19.00	17.00	15.00	1.00	12	740

Due to continuous development of our product range we reserve the right to change the dimensions and information contained in the leaflet as required.

# SHARPE VALVES

## SERIES 45 STAINLESS STEEL 300# FLANGED GLOBE

### DESIGN DESCRIPTION:

- OUTSIDE SCREW AND YOKE
- BOLTED BONNET
- RISING STEM AND HANDWHEEL (IMPACT-HAMMER HANDWHEEL FOR 8" & OVER.)
- YOKE INTEGRAL WITH BONNET
- LOOSE DISC
- INTEGRAL SEAT AND BACK SEAT
- AVAILABLE WITH GEAR OPERATOR
- FLANGED ENDS
- BUTTWELDING ENDS

### APPLICABLE STANDARDS:

- STEEL VALVES, ANSI B16.34
- FACE TO FACE, ANSI B16.10
- END FLANGES, ANSI B16.5
- BUTTWELDING ENDS, ANSI B16.25
- INSPECTION AND TEST, API 598

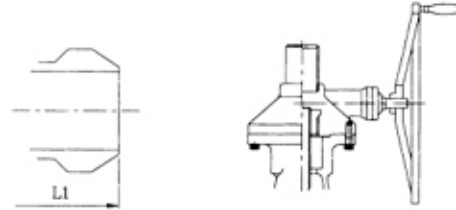

Buttwelding Ends

Available With Gear Operator

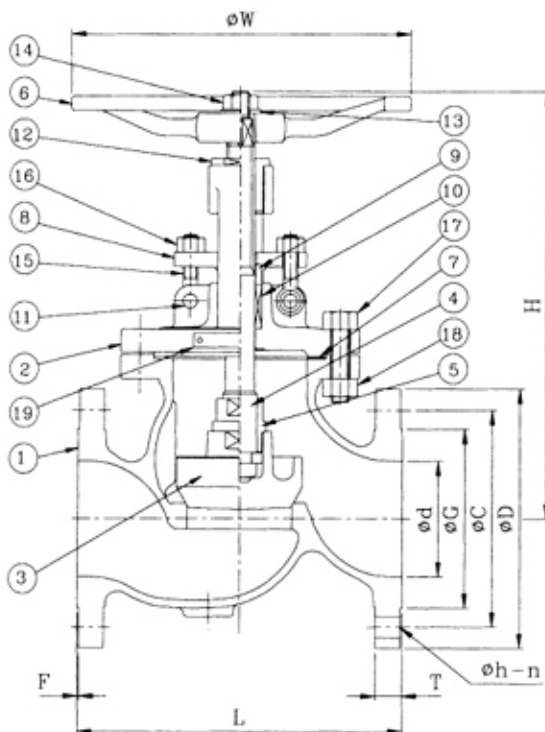

### PARTS AND MATERIAL (ASTM)

NO.	PARTS NAME	MATERIALS
		CF8M
1	Body	A351 - CF8M
2	Bonnet	A351 - CF8M
3	Disc	A351 - CF8M
4	Stem	A182 - F316
5	Disc Nut	A276 - 316
6	Hand Wheel	A47 / A536
7	Gasket	316 Spiralwound
8	Gland Flange	A351 - CF8
9	Gland	A351 - CF8M
10	Gland packing	PTFE / Graphite
11	Eye Bolt Pin	A276 - 304
12	Stem Nut	A439 - D2 / A276 - 410
13	Washer	A240 - 304
14	Wheel Nut	AISI 304
15	Eye Bolt	A193 - B8
16	Eye Bolt Nut	A194 - 8
17	Bonnet Bolt	A193 - B8
18	Bonnet Bolt Nut	A194 - 8
19	Name Plate	A666-304

OTHER MATERIALS ARE AVAILABLE UPON REQUEST.

### TEST PRESSURE TO API 598

PSIG

SHELL TEST (water)	SEAT TEST (water)	SEAT TEST (air)
1125	814	80

### DIMENSION TABLE:

Size	$\phi d$	L	L1	H(OPEN)	$\phi W$	T	F	$\phi D$	$\phi C$	$\phi G$	$\phi h$	n	WT.(lbs.)
1/2	0.5	6.00	6.00	6.50	4.00	0.56	0.06	3.75	2.62	1.38	0.63	4	10
3/4	0.75	7.00	7.00	6.90	4.00	0.63	0.06	4.63	3.25	1.70	0.75	4	12
1	1.00	8.00	8.00	6.90	5.50	0.69	0.06	4.88	3.50	2.00	0.75	4	22
1 1/2	1.50	9.00	9.00	7.90	6.30	0.81	0.06	6.12	4.50	2.88	0.88	4	33
2	2.00	10.50	10.50	8.90	7.10	0.88	0.06	6.50	5.00	3.63	0.88	8	42
2 1/2	2.50	11.50	11.50	11.90	7.90	1.00	0.06	7.50	5.88	4.13	0.88	8	66
3	3.00	12.50	12.50	13.00	8.70	1.12	0.06	8.25	6.62	5.00	0.88	8	84
4	4.00	14.00	14.00	15.35	9.85	1.25	0.06	10.00	7.88	6.18	0.88	8	124
6	6.00	17.50	17.50	20.00	13.40	1.44	0.06	12.50	10.62	8.50	0.88	12	225
8	8.00	22.00	22.00	22.50	15.75	1.63	0.06	15.00	13.00	10.62	1.00	12	357
10	10.00	24.50	24.50	24.80	17.75	1.88	0.06	17.50	15.25	12.75	1.12	16	924
12	12.00	28.00	28.00	28.40	19.70	2.00	0.06	20.50	17.75	15.00	1.25	16	1420

Due to continuous development of our product range we reserve the right to change the dimensions and information contained in the leaflet as required.



# SHARPE VALVES

## SERIES 45 CAST STEEL 150# FLANGED GLOBE

### DESIGN DESCRIPTION:

- OUTSIDE SCREW AND YOKE
- BOLTED BONNET
- STEM/WEDGE CONNECTION MEETS THE API 600 PULL TEST
- WELDED SEAT
- RISING STEM AND HANDWHEEL (IMPACT-HAMMER HANDWHEEL FOR 10" & OVER.)
- YOKE INTEGRAL WITH BONNET
- LOOSE DISC
- RENEWABLE SEAT RINGS
- FLANGED ENDS
- BUTTWELDING ENDS

### APPLICABLE STANDARDS:

- STEEL VALVES, ANSI B16.34
- FACE TO FACE, ANSI B16.10
- END FLANGES, ANSI B16.5
- BUTTWELDING ENDS, ANSI B16.25
- INSPECTION AND TEST, API 598

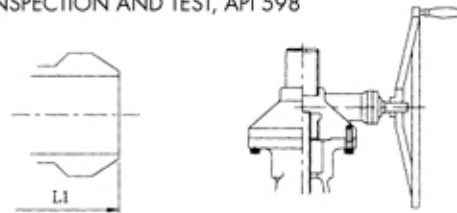

Buttwelding Ends

Available With Gear Operator

### PARTS AND MATERIAL (ASTM)

NO.	PARTS NAME	MATERIALS		
		WCB	WC6	LCB
1	Body	A216 - WCB	A217 - WC6	A352 - LCB
2	Bonnet	A216 - WCB	A217 - WC6	A352 - LCB
3	Disc	A216 - WCB + H/F 410	A217 - WC6 + H/F 410	A352 - LCB + H/F 410
4	Stem	A276 - 410		
5	Seat	A105 + H/F STL#6	A182 - F11 + H/F STL#6	A350 - IP2 + H/F STL#6
6	Disc Nut	A276 - 410		
7	Back Seat	A276 - 410		
8	Hand Wheel	A47 / A536		
9	Gasket	Grafoil + 316 Sheet		
10	Gland Flange	A216 - WCB		
11	Gland	A276 - 410		
12	Gland Packing	Graphite		
13	Eye Bolt Pin	A276 - 410		
14	Stem Nut	A439 - D2		
15	Washer	A36 + Zn Plate		
16	Wheel Nut	A194 - 2H		
17	Eye Bolt	A307 B		
18	Eye Bolt Nut	A194 - 2H		
19	Bonnet Bolt	A193 - B7	A193 - B7	A193 - B7M
20	Bonnet Bolt Nut	A194 - 2H	A194 - 2H	A194 - 2HM
21	Name Plate	A666 - 304		

OTHER MATERIALS ARE AVAILABLE UPON REQUEST.

### TEST PRESSURE TO API 598

PSIG

SHELL TEST (water)	SEAT TEST (water)	SEAT TEST (air)
450	314	80

### DIMENSION TABLE:

Size	Ød	L & L1	H	H <sub>(OPEN)</sub>	ØW	T	F	ØD	ØG	Øh	n	WT. (lbs.)
2	2	8	14.75	15	7.9	0.62	0.063	6	3.62	0.75	4	49
2 1/2	2.5	8.50	16.00	16.90	9.9	0.69	0.063	7	4.12	0.75	4	69
3	3	9.50	17.20	18.45	11.85	0.75	0.063	7.5	5	0.75	4	91
4	4	11.50	19.60	21.10	11.85	0.94	0.063	9	6.18	0.75	8	141
6	6	16	23.25	25.30	15.75	1	0.063	11	8.50	0.88	8	249
8	8	19.50	27	29.80	17.75	1.12	0.063	13.50	10.62	0.88	8	420
10	10	24.50	31	33.60	19.70	1.20	0.063	16	12.75	1.00	12	529
12	12	27.50	34.90	38.80	23.65	1.25	0.063	19	14.50	1.00	12	925
14	13.25	31.00	38.90	43.65	27.50	1.38	0.063	21	16.25	1.12	12	1410
16	15.25	36.00	42.75	48.25	31.50	1.44	0.063	23.50	18.50	1.12	16	2020

Due to continuous development of our product range we reserve the right to change the dimensions and information contained in the leaflet as required.

# SHARPE VALVES

## SERIES 45 CAST STEEL 300# FLANGED GLOBE

### DESIGN DESCRIPTION:

- OUTSIDE SCREW AND YOKE
- BOLTED BONNET
- STEM/WEDGE CONNECTION MEETS THE API 600 PULL TEST
- RISING STEM AND HANDWHEEL (IMPACT-HAMMER HANDWHEEL FOR 8" & OVER.)
- YOKE INTEGRAL WITH BONNET
- LOOSE DISC
- WELDED SEAT
- RENEWABLE SEAT RINGS
- AVAILABLE WITH GEAR OPERATOR
- FLANGED ENDS
- BUTTWELDING ENDS

### APPLICABLE STANDARDS:

- STEEL VALVES, ANSI B16.34
- FACE TO FACE, ANSI B16.10
- END FLANGES, ANSI B16.5
- BUTTWELDING ENDS, ANSI B16.25
- INSPECTION AND TEST, API 598

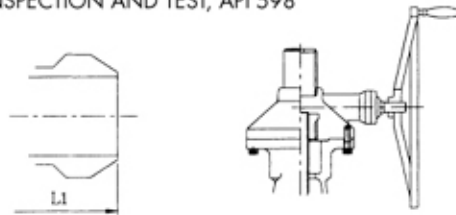

Buttwelding Ends

Available With Gear Operator

### PARTS AND MATERIAL (ASTM)

NO.	PARTS NAME	MATERIALS		
		WCB	WC6	LCB
1	Body	A216 - WCB	A217 - WC6	A352 - LCB
2	Bonnet	A216 - WCB	A217 - WC6	A352 - LCB
3	Disc	A216 - WCB + H/F 410	A217 - WC6 + H/F 410	A352 - LCB + H/F 410
4	Stem	A276 - 410		
5	Seat	A105 + H/F STL#6	A182 - F11 + H/F STL#6	A350 - LCB + H/F STL #6
6	Disc Nut	A276 - 410		
7	Back Seat	A276 - 410		
8	Hand Wheel	A47 / A536		
9	Gasket	304 Spiralwound w/ Grafoil Filler		
10	Gland Flange	A216 - WCB		
11	Gland	A276 - 410		
12	Gland Packing	Graphite		
13	Eye Bolt Pin	A276 - 410		
14	Stem Nut	A439 - D2		
15	Washer	A36 + Zn Plate		
16	Wheel Nut	A194 - 2H		
17	Eye Bolt	A307 B		
18	Eye Bolt Nut	A194 - 2H		
19	Bonnet Bolt	A193 - B7	A193 - B7	A193 - B7M
20	Bonnet Bolt Nut	A194 - 2H	A194 - 2H	A194 - 2HM
21	Name Plate	A666 - 304		

OTHER MATERIALS ARE AVAILABLE UPON REQUEST.

### TEST PRESSURE TO API 598

PSIG

SHELL TEST (water)	SEAT TEST (water)	SEAT TEST (air)
1125	814	80

### DIMENSION TABLE:

Size	Ød	L & L1	H	H(OPEN)	ØW	T	F	ØD	ØG	Øh	n	WT.(lbs.)
2	2	10.50	15.95	16.65	7.9	0.88	0.063	6.5	3.62	0.75	8	64
2 1/2	2.5	11.50	17.50	18.45	9.9	1	0.063	7.5	4.12	0.88	8	95
3	3	12.50	19.30	20.50	11.85	1.12	0.063	8.25	5.00	0.88	8	125
4	4	14	22.30	23.90	11.85	1.25	0.063	10	6.18	0.88	8	190
6	6	17.50	28.85	30.90	15.75	1.44	0.063	12.50	8.50	0.88	12	388
8	8	22	31.40	34.20	19.70	1.62	0.063	15.00	10.62	1.00	12	616
10	10	24.50	38.30	41.00	23.65	1.88	0.063	17.50	12.75	1.12	16	925
12	12	28	40.55	44.90	27.50	2	0.063	20.50	15.00	1.25	16	1420
14	14.43	33	43.00	45.45	31.50	2.12	0.063	23	16.25	1.25	20	1936
16	15.25	34	45	47.50	35.50	2.25	0.063	25.50	18.50	1.38	20	2816

Due to continuous development of our product range we reserve the right to change the dimensions and information contained in the leaflet as required.

# SHARPE VALVES

## SERIES 45 CAST STEEL 600# FLANGED GLOBE

### DESIGN DESCRIPTION:

- OUTSIDE SCREW AND YOKE
- BOLTED BONNET
- STEM/WEDGE CONNECTION MEETS THE API 600 PULL TEST
- RISING STEM AND HANDWHEEL (IMPACT HAMMER HANDWHEEL FOR 6" & OVER.)
- YOKE INTEGRAL WITH BONNET
- LOOSE DISC
- WELDED SEAT
- RENEWABLE SEAT RING
- AVAILABLE WITH GEAR OPERATOR
- FLANGED ENDS
- BUTTWELDING ENDS

### APPLICABLE STANDARDS:

- STEEL VALVES, ANSI B16.34
- FACE TO FACE, ANSI B16.10
- END FLANGES, ANSI B16.5
- BUTTWELDING ENDS, ANSI B16.25
- INSPECTION AND TEST, API 598

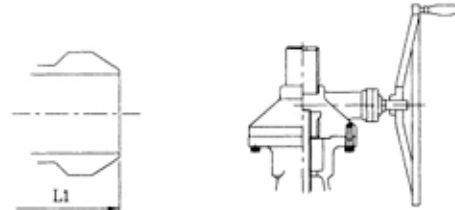

Buttwelding Ends

Available With Gear Operator

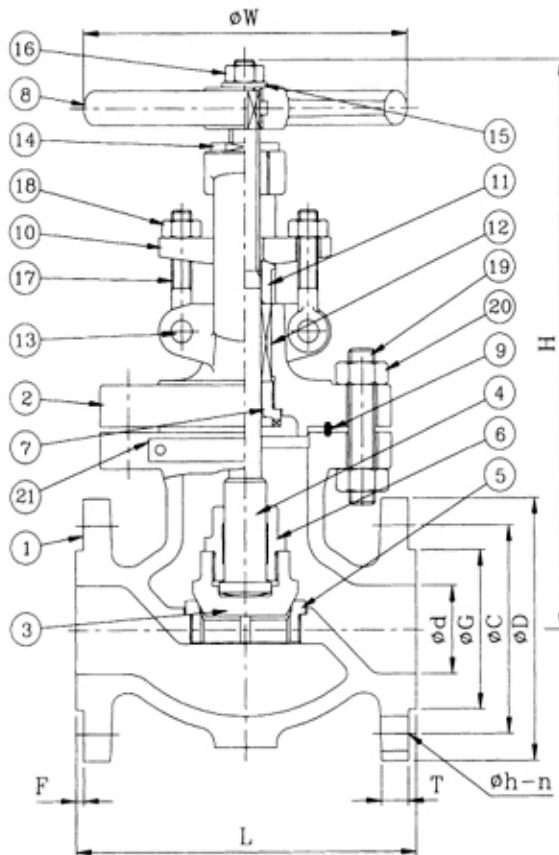

### PARTS AND MATERIAL (ASTM)

NO.	PARTS NAME	MATERIALS		
		WCB	WC6	LCB
1	Body	A216 - WCB	A217 - WC6	A352 - LCB
2	Bonnet	A216 - WCB	A217 - WC6	A352 - LCB
3	Disc	A216 - WCB + H/F 410	A217 - WC6 + H/F 410	A352 - LCB + H/F 410
4	Stem	A276 - 410		
5	Seat	A105 + H/F ST1#6	A182 - F11 + H/F ST1#6	A350 - IF2 + H/F ST #6
6	Disc Nut	A276 - 410		
7	Back Seat	A276 - 410		
8	Hand Wheel	A47 / A536		
9	Gasket	Soft Iron		
10	Gland Flange	A216 - WCB		
11	Gland	A276 - 410		
12	Gland Packing	Graphite		
13	Eye Bolt Pin	A276 - 410		
14	Stem Nut	A439 - D2		
15	Washer	A36 + Zn Plate		
16	Wheel Nut	A194 - 2H		
17	Eye Bolt	A193 - B7		
18	Eye Bolt Nut	A194 - 2H		
19	Bonnet Bolt	A193 - B7	A193 - B7	A193 - B7M
20	Bonnet Bolt Nut	A194 - 2H	A194 - 2H	A194 - 2HM
21	Name Plate	A666 - 304		

OTHER MATERIALS ARE AVAILABLE UPON REQUEST.

### TEST PRESSURE TO API 598

PSIG

SHELL TEST (water)	SEAT TEST (water)	SEAT TEST (air)
2250	1628	80

### DIMENSION TABLE:

Size	$\phi d$	L & L1	H	H(OOPEN)	$\phi W$	T	F	$\phi D$	$\phi C$	$\phi G$	$\phi h$	n	WT.(lbs.)
2	2	11.50	16.93	17.50	9.85	1	0.25	6.50	5	3.63	0.75	8	90
2 1/2	2.5	13.00	19.70	20.50	9.85	1.12	0.25	7.50	5.88	4.12	0.88	8	130
3	3	14.00	20.90	22.25	11.80	1.25	0.25	8.25	6.62	5.00	0.88	8	170
4	4	17.00	25.60	26.65	15.75	1.50	0.25	10.75	10.00	6.18	1.00	8	270
6	6	22.00	41.35	35.00	22.85	1.88	0.25	14.00	11.50	8.50	1.12	12	570
8	7.9	26.00	41.35	44.00	23.65	2.18	0.25	16.50	13.75	10.62	1.25	12	900
10	9.75	31.00	49.50	52.75	25.60	2.50	0.25	17.00	17.00	12.75	1.37	16	1370
12	11.75	33.00	57.80	61.80	25.60	2.62	0.25	22.00	19.25	15.00	1.37	20	1895

Due to continuous development of our product range we reserve the right to change the dimensions and information contained in the leaflet as required.

# SHARPE VALVES

## SERIES 25 STAINLESS STEEL 150# FLANGED SWING CHECK

### DESIGN DESCRIPTION:

- BOLTED COVER
- SWING TYPE
- FOR HORIZONTAL OR VERTICAL LINES
- INTEGRAL SEAT
- FLANGED ENDS
- BUTTWELDING ENDS

### APPLICABLE STANDARDS:

- STEEL VALVES, ANSI B16.34
- FACE TO FACE, ANSI B16.10
- END FLANGES, ANSI B16.5
- BUTTWELDING ENDS, ANSI B16.25
- INSPECTION AND TEST, API 598

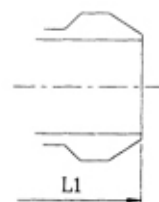
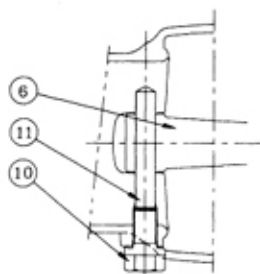
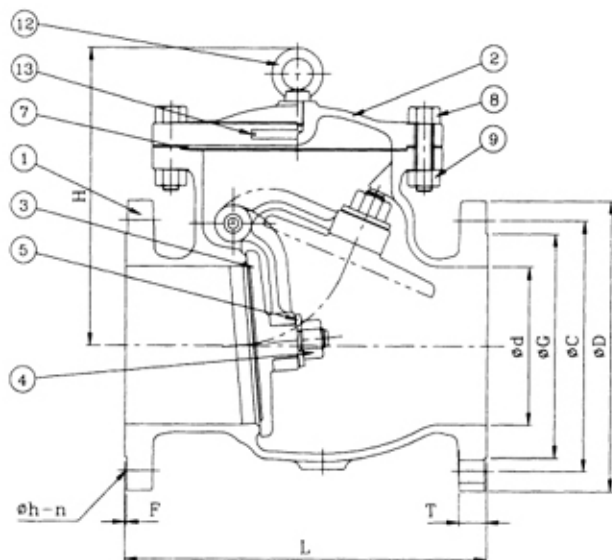

Buttwelding Ends

### PARTS AND MATERIAL (ASTM)

NO.	PARTS NAME	MATERIALS
		CF8M
1	Body	A351 - CF8M
2	Cover	A351 - CF8M
3	Disc	A351 - CF8M
4	Disc Nut	A194 - 8M
5	Disc Washer	A276 - 316
6	Swing Arm	A351 - CF8M
7	Gasket	PTFE / Grafoil + 316 Sheet
8	Cover Bolt	A193 - 8B
9	Cover Bolt Nut	A194 - 8
10	Plug	A276 - 316
11	Hinge Pin	A276 - 316
12	Eye Bolt	A36 + Zn Plate
13	Name Plate	A666 - 304

OTHER MATERIALS ARE AVAILABLE UPON REQUEST.

### TEST PRESSURE TO API 598

PSIG

SHELL TEST (water)	SEAT TEST (water)	SEAT TEST (air)
450	314	80

### DIMENSION TABLE:

Size	$\phi d$	L & L1	H	T	F	$\phi D$	$\phi C$	$\phi G$	$\phi h$	n	WT.(lbs.)
1/2	0.50	4.25	2.80	0.40	0.06	3.50	2.38	1.38	0.63	4	5.50
3/4	0.75	4.60	2.80	0.41	0.06	3.88	2.75	1.70	0.63	4	7.00
1	1.00	5.00	3.00	0.44	0.06	4.25	3.12	2.00	0.63	4	9.00
1 1/2	1.50	6.50	4.80	0.56	0.06	5.00	3.88	2.88	0.63	4	15.00
2	2.00	8.00	5.60	0.63	0.06	6.00	4.75	3.62	0.63	4	20.50
2 1/2	2.50	8.50	5.85	0.69	0.06	7.00	5.50	4.12	0.63	4	34.50
3	3.00	9.50	6.33	0.75	0.06	7.50	6.00	5.00	0.63	4	42.00
4	4.00	11.50	7.36	0.94	0.06	9.00	7.50	6.20	0.63	8	65.00
6	6.00	14.00	11.30	1.00	0.06	11.00	9.50	8.50	0.88	8	135.00
8	8.00	19.50	12.50	1.12	0.06	13.50	11.75	10.62	0.88	8	235.00
10	10.00	24.50	15.50	1.19	0.06	16.00	14.25	12.75	1.00	12	360
12	12.00	27.50	16.85	1.25	0.06	19.00	17.00	15.00	1.00	12	520
14	13.25	31.00	17.85	1.38	0.06	21.00	18.75	16.25	1.12	12	805
16	15.25	34.00	19.30	1.44	0.06	23.50	21.25	18.50	1.12	16	1185
18	17.25	38.50	20.50	1.56	0.06	25.00	22.75	21.00	1.25	16	1600

Due to continuous development of our product range we reserve the right to change the dimensions and information contained in the leaflet as required.

# SHARPE VALVES

## SERIES 25 STAINLESS STEEL 300# FLANGED SWING CHECK

### DESIGN DESCRIPTION:

- BOLTED COVER
- SWING TYPE
- FOR HORIZONTAL OR VERTICAL LINES
- INTEGRAL SEAT
- FLANGED ENDS
- BUTTWELDING ENDS

### APPLICABLE STANDARDS:

- STEEL VALVES, ANSI B16.34
- FACE TO FACE, ANSI B16.10
- END FLANGES, ANSI B16.5
- BUTTWELDING ENDS, ANSI B16.25
- INSPECTION AND TEST, API 598

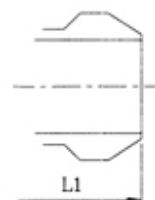
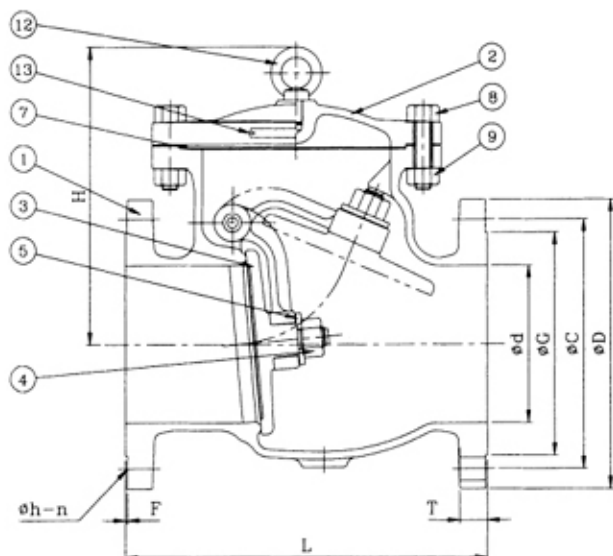

Buttwelding Ends

### PARTS AND MATERIAL (ASTM)

NO.	PARTS NAME	MATERIALS
		CF8M
1	Body	A351 - CF8M
2	Cover	A351 - CF8M
3	Disc	A351 - CF8M
4	Disc Nut	A194 - 8M
5	Disc Washer	A276 - 316
6	Swing Arm	A351 - CF8M
7	Gasket	316 Spiralwound
8	Cover Bolt	A193 - B8
9	Cover Bolt Nut	A194 - 8
10	Plug	A276 - 316
11	Hinge Pin	A276 - 316
12	Eye Bolt	A36 + Zn Plate
13	Name Plate	A666 - 304

OTHER MATERIALS ARE AVAILABLE UPON REQUEST.

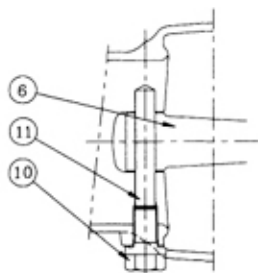

### DIMENSION TABLE:

Size	Ød	L & L1	H	T	F	ØD	ØC	ØG	Øh	n	WT.(lbs.)
1/2	.50	6.00	3.15	0.56	0.06	3.75	2.62	1.38	0.63	4	9
3/4	.75	7.00	3.55	0.63	0.06	4.63	3.25	1.70	0.75	4	11
1	1.00	8.50	4.00	0.69	0.06	4.88	3.50	2.00	0.75	4	16
1 1/2	1.50	9.50	4.60	0.81	0.06	6.13	4.50	2.88	0.88	4	25
2	2.00	10.50	5.00	0.88	0.06	6.50	5.00	3.63	0.88	8	40
2 1/2	2.50	11.50	5.65	1.00	0.06	7.50	5.88	4.13	0.88	8	53
3	3.00	12.50	6.45	1.12	0.06	8.25	6.62	5.00	0.88	8	71
4	4.00	14.00	7.00	1.25	0.06	10.00	7.88	6.18	0.88	8	107
6	6.00	17.50	9.00	1.44	0.06	12.50	10.63	8.50	0.88	12	185
8	8.00	21.00	11.45	1.62	0.06	15.00	13.00	10.62	1.00	12	432
10	10.00	24.50	12.55	1.88	0.06	17.50	15.25	12.75	1.12	16	645
12	12.00	28.00	14.20	2.00	0.06	20.50	17.75	15.00	1.25	16	990
14	13.25	33.00	18.50	2.12	0.06	23.00	20.25	16.25	1.25	20	1514
16	15.25	34.00	21.00	2.25	0.06	25.50	22.50	18.50	1.38	20	1892

Due to continuous development of our product range we reserve the right to change the dimensions and information contained in the leaflet as required.

### TEST PRESSURE TO API 598

PSIG

SHELL TEST (water)	SEAT TEST (water)	SEAT TEST (air)
1125	814	80

# SHARPE VALVES

## SERIES 25 CAST STEEL 150# FLANGED SWING CHECK

### DESIGN DESCRIPTION:

- BOLTED COVER
- SWING TYPE
- FOR HORIZONTAL OR VERTICAL LINES
- WELDED SEAT
- RENEWABLE SEAT RINGS
- FLANGED ENDS
- BUTTWELDING ENDS

### APPLICABLE STANDARDS:

- STEEL VALVES, ANSI B16.34
- FACE TO FACE, ANSI B16.10
- END FLANGES, ANSI B16.5
- BUTTWELDING ENDS, ANSI B16.25
- INSPECTION AND TEST, API 598

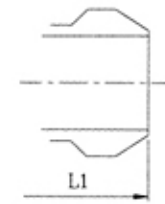
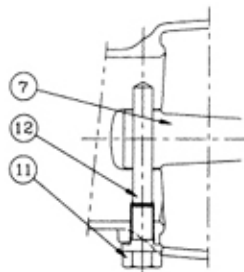
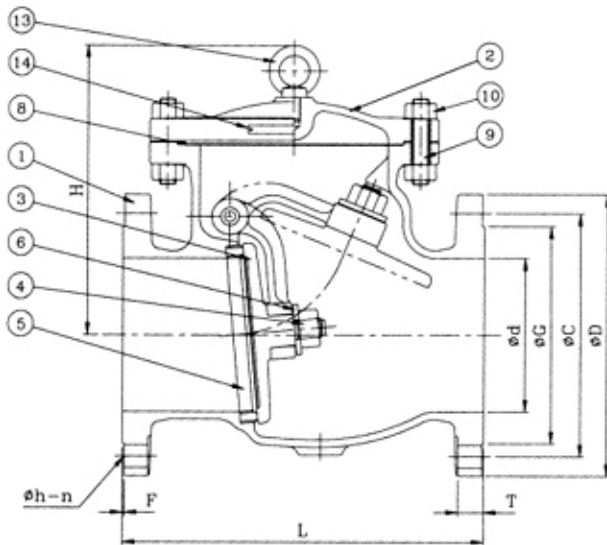

Buttwelding Ends

### PARTS AND MATERIAL (ASTM)

NO.	PARTS NAME	MATERIALS		
		WC6	WC6	LCB
1	Body	A216 - WCB	A217 - WC6	A352 - LCB
2	Cover	A216 - WCB	A217 - WC6	A352 - LCB
3	Disc	A216 - WCB + H/F 410	A217 - WC6 + H/F 410	A352 - LCB + H/F 410
4	Disc Nut	A194 - 8		
5	Seat Ring	A105 + H/F STL#6	A217 - WC6 + H/F STL#6	A350 - LF2 + H/F STL#6
6	Disc Washer	A276 - 304		
7	Swing Arm	A216 - WCB	A217 - WC6	A352 - LCB
8	Gasket	Grafoil + 316 Sheet		
9	Cover Bolt	A193 - B7	193 - B7	A193 - B7M
10	Cover Bolt Nut	A194 - 2H	A194 - 2H	A194 - 2HM
11	Plug	A276 - 410		
12	Hinge Pin	A276 - 410		
13	Eye Bolt	A36 + Zn Plate		
14	Name Plate	A666 - 304		

OTHER MATERIALS ARE AVAILABLE UPON REQUEST.

### TEST PRESSURE TO API 598

PSIG

SHELL TEST (water)	SEAT TEST (water)	SEAT TEST (air)
450	314	80

### DIMENSION TABLE:

Size	Ød	L & L1	H	T	F	ØD	ØC	ØG	Øh	n	WT. (lbs.)
2	2.00	8.00	6.70	0.62	0.06	6.00	4.75	3.62	0.75	4	36
2 1/2	2.50	8.50	7.00	0.69	0.06	7.00	5.50	4.12	0.75	4	55
3	3.00	9.50	7.70	0.75	0.06	7.50	6.00	5.00	0.75	4	64
4	4.00	11.50	8.50	0.94	0.06	9.00	7.50	6.18	0.75	8	91
6	6.00	14.00	10.60	1.00	0.06	11.00	9.50	8.50	0.88	8	168
8	8.00	19.50	12.40	1.12	0.06	13.50	11.75	10.62	0.88	8	277
10	10.00	24.50	14.20	1.20	0.06	16.00	14.25	12.75	1.00	12	445
12	12.00	27.50	15.80	1.25	0.06	19.00	17.00	15.00	1.00	12	674
14	13.25	31.00	18.15	1.38	0.06	21.00	18.75	16.25	1.12	12	925
16	15.25	36.00	19.30	1.44	0.06	23.50	21.25	18.50	1.12	16	1210
18	17.25	38.50	22.00	1.56	0.06	25.00	22.75	21.00	1.25	16	1675
20	19.25	38.50	24.40	1.70	0.06	27.50	24.50	23.00	1.25	20	1805
24	23.25	51.00	27.55	1.88	0.06	32.00	29.50	27.25	1.38	20	2860

Due to continuous development of our product range we reserve the right to change the dimensions and information contained in the leaflet as required.

# SHARPE VALVES

## SERIES 25 CAST STEEL 300# FLANGED SWING CHECK

### DESIGN DESCRIPTION:

- BOLTED COVER
- SWING TYPE
- FOR HORIZONTAL OR VERTICAL LINES
- WELDED SEAT
- RENEWABLE SEAT RINGS
- FLANGED ENDS
- BUTTWELDING ENDS

### APPLICABLE STANDARDS:

- STEEL VALVES, ANSI B16.34
- FACE TO FACE, ANSI B16.10
- END FLANGES, ANSI B16.5
- BUTTWELDING ENDS, ANSI B16.25
- INSPECTION AND TEST, API 598

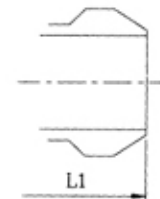
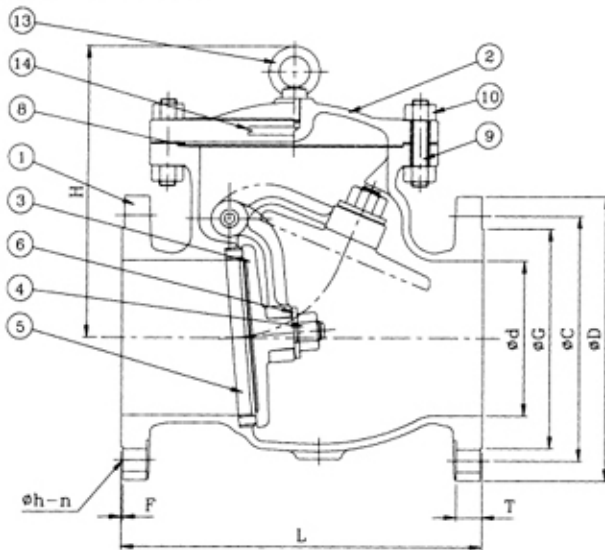

Buttwelding Ends

### PARTS AND MATERIAL (ASTM)

NO.	PARTS NAME	MATERIALS		
		WCB	WC6	LCB
1	Body	A216 - WCB	A217 - WC6	A352 - LCB
2	Cover	A216 - WCB	A217 - WC6	A352 - LCB
3	Disc	A216 - WCB + H/F 410	A217 - WC6 + H/F 410	A352 - LCB + H/F 410
4	Disc Nut	A194 - B		
5	Seat Ring	A105 + H/F STL#6	A217 - WC6 + H/F STL#6	A350 - LF2 + H/F STL#6
6	Disc Washer	A276 - 304		
7	Swing Arm	A216 - WCB	A217 - WC6	A352 - LCB
8	Gasket	304 Spiralwound w/ Grafoil Filler		
9	Cover Bolt	A193 - B7	193 - B7	A193 - B7M
10	Cover Bolt Nut	A194 - 2H	A194 - 2H	A194 - 2HM
11	Plug	A276 - 410		
12	Hinge Pin	A276 - 410		
13	Eye Bolt	A36 + Zn Plote		
14	Name Plate	A666 - 304		

OTHER MATERIALS ARE AVAILABLE UPON REQUEST.

### TEST PRESSURE TO API 598

PSIG

SHELL TEST (water)	SEAT TEST (water)	SEAT TEST (air)
1125	814	80

### DIMENSION TABLE:

Size	Ød	L & L1	H	T	F	ØD	ØC	ØG	Øh	n	WT. (lbs.)
2	2	10.50	6.85	0.88	0.06	6.50	5.00	3.62	0.75	8	51
2 1/2	2.5	11.50	7.00	1.00	0.06	7.50	5.88	4.12	0.88	8	75
3	3	12.50	8.70	1.12	0.06	8.25	6.62	5.00	0.88	8	91
4	4	14.00	9.30	1.25	0.06	10.00	7.88	6.18	0.88	8	150
6	6	17.50	12.20	1.44	0.06	12.50	10.63	8.50	0.88	12	275
8	8	21.00	13.70	1.62	0.06	15.00	13.00	10.62	1.00	12	432
10	10	24.50	15.00	1.88	0.06	17.50	15.25	12.75	1.12	16	643
12	12	28.00	16.85	2.00	0.06	20.50	17.75	15.00	1.25	16	990
14	13.25	33.00	19.00	2.12	0.06	23.00	20.25	16.25	1.25	20	1514
16	15.25	34.00	21.00	2.25	0.06	25.50	22.50	18.50	1.38	20	1892
18	17.25	38.50	24.00	2.38	0.06	28.00	24.75	21.00	1.38	24	2332
20	19.25	40.00	26.80	2.50	0.06	30.50	27.00	23.00	1.38	24	2836
24	23.25	53.00	29.80	2.75	0.06	36.00	32.00	27.25	1.61	24	3630

Due to continuous development of our product range we reserve the right to change the dimensions and information contained in the leaflet as required.

# SHARPE VALVES

## SERIES 25 CAST STEEL 600# FLANGED SWING CHECK

### DESIGN DESCRIPTION:

- BOLTED COVER
- SWING TYPE
- FOR HORIZONTAL OR VERTICAL LINES
- WELDED SEAT
- RENEWABLE SEAT RINGS
- FLANGED ENDS
- BUTTWELDING ENDS

### APPLICABLE STANDARDS:

- STEEL VALVES, ANSI B16.34
- FACE TO FACE, ANSI B16.10
- END FLANGES, ANSI B16.5
- BUTTWELDING ENDS, ANSI B16.25
- INSPECTION AND TEST, API 598

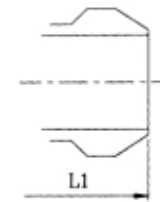
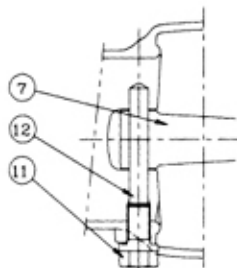
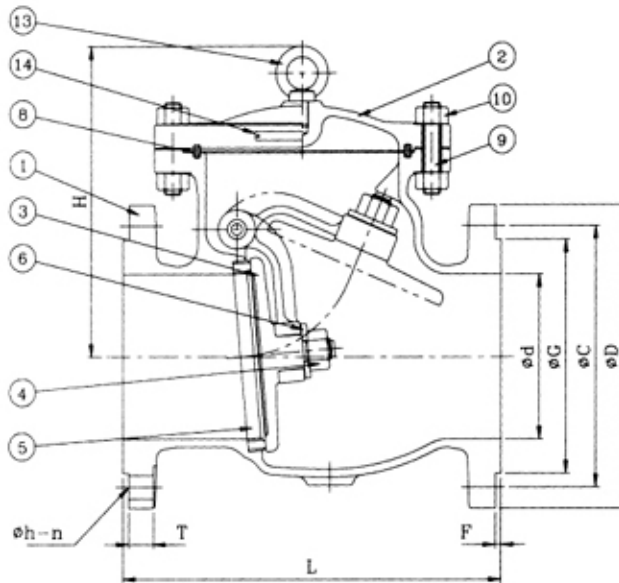

Buttwelding Ends

### PARTS AND MATERIAL (ASTM)

NO.	PARTS NAME	MATERIALS		
		WCB	WC6	LCB
1	Body	A216 - WCB	A217 - WC6	A352 - LCB
2	Cover	A216 - WCB	A217 - WC6	A352 - LCB
3	Disc	A216 - WCB + H/F 410	A217 - WC6 + H/F 410	A352 - LCB + H/F 410
4	Disc Nut	A194 - 8		
5	Seat Ring	A105 + H/F STL#6	A217 - WC6 + H/F STL#6	A350 - IP2 + H/F STL#6
6	Disc Washer	A276 - 304		
7	Swing Arm	A216 - WCB	A217 - WC6	A352 - LCB
8	Gasket	Soft Iron		
9	Cover Bolt	A193 - B7	193 - B7	A193 - B7M
10	Cover Bolt Nut	A194 - 2H	A194 - 2H	A194 - 2HM
11	Plug	A276 - 410		
12	Hinge Pin	A276 - 410		
13	Eye Bolt	A36		
14	Name Plate	A666 - 304		

OTHER MATERIALS ARE AVAILABLE UPON REQUEST.

### TEST PRESSURE TO API 598

PSIG

SHELL TEST (water)	SEAT TEST (water)	SEAT TEST (air)
2225	1628	80

### DIMENSION TABLE:

Size	Ød	L & L1	H	T	F	ØD	ØC	ØG	Øh	n	WT.(lbs.)
2	2	11.50	8	1.00	0.25	6.50	5	3.36	0.75	8	75
2 1/2	2.5	13.00	8.27	1.12	0.25	7.50	5.89	4.12	0.88	8	99
3	3	14.00	9.25	1.25	0.25	8.25	6.63	5.00	0.88	8	139
4	4	17.00	11.25	1.50	0.25	10.75	8.50	6.19	1.00	8	251
6	6	22.00	13.00	1.88	0.25	14.00	11.50	8.50	1.12	12	456
8	7.88	26.00	15.00	2.19	0.25	16.50	13.75	10.62	1.25	12	801
10	9.75	31.00	18.00	2.50	0.25	20.00	17.00	12.75	1.38	16	1232
12	11.75	33.00	23.00	2.62	0.25	22.00	19.25	15.00	1.38	20	1743
14	12.87	35.00	25.00	2.75	0.25	23.75	20.75	16.25	1.50	20	2380
16	14.75	39.00	27.30	3.00	0.25	27.00	23.75	18.50	1.62	20	2757

Due to continuous development of our product range we reserve the right to change the dimensions and information contained in the leaflet as required.



### CLASS 150

TEMPERATURE °F	Working pressure (psig)					
	WCB(1)	WC6(2)	WC9(2)	LCB(3)	CF8(4)	CF8M(4)
-20 to 100	285	290	290	265	275	275
200	260	260	260	250	230	235
300	230	230	230	230	205	215
400	200	200	200	200	190	195
500	170	170	170	170	170	170
600	140	140	140	140	140	140
650	125	125	125	125	125	125
700	110	110	110	110	110	110
750	95	95	95	95	95	95
800	80	80	80	80	80	80
850	85	65	65	65	65	65
900	50	50	50	50	50	50
950	35	35	35	35	35	35
1000	20	20	20	20	20	20
1050	—	20*	20*	—	20*	20*
1100	—	20*	20*	—	20*	20*
1150	—	20*	20*	—	20*	20*
1200	—	15*	20*	—	20*	20*

### CLASS 600

TEMPERATURE °F	Working pressure (psig)					
	WCB(1)	WC6(2)	WC9(2)	LCB(3)	CF8(4)	CF8M(4)
-20 to 100	1480	1500	1500	1390	1440	1440
200	1350	1500	1500	1315	1200	1240
300	1315	1445	1455	1275	1080	1120
400	1270	1385	1410	1235	995	1025
500	1200	1330	1330	1165	930	955
600	1095	1210	1210	1065	875	900
650	1075	1175	1175	1045	860	890
700	1065	1135	1135	1035	850	870
750	1010	1065	1065	945	830	855
800	825	1015	1015	780	805	845
850	535	975	975	535	790	835
900	345	900	900	345	780	830
950	205	640	755	205	765	775
1000	105	430	520	105	640	700
1050	—	290	350	—	615	685
1100	—	190	220	—	515	610
1150	—	125	135	—	400	475
1200	—	75	80	—	310	370

### CLASS 1500

TEMPERATURE °F	Working pressure (psig)					
	WCB(1)	WC6(2)	WC9(2)	LCB(3)	CF8(4)	CF8M(4)
-20 to 100	3705	3750	3750	3470	3600	3600
200	3375	3750	3750	3280	3000	3095
300	3280	3610	3640	3190	2700	2795
400	3170	3465	3530	3085	2485	2570
500	2995	3325	3325	2910	2330	2390
600	2735	3025	3025	2665	2185	2255
650	2685	2940	2940	2615	2150	2220
700	2665	2840	2840	2590	2125	2170
750	2520	2660	2660	2365	2075	2135
800	2060	2540	2540	1955	2015	2110
850	1340	2435	2435	1340	1980	2090
900	860	2245	2245	860	1945	2075
950	515	1595	1885	515	1910	1930
1000	260	1080	1305	260	1605	1750
1050	—	720	875	—	1545	1720
1100	—	480	550	—	1285	1525
1150	—	310	345	—	995	1185
1200	—	190	205	—	770	925

### CLASS 300

TEMPERATURE °F	Working pressure (psig)					
	WCB(1)	WC6(2)	WC9(2)	LCB(3)	CF8(4)	CF8M(4)
-20 to 100	740	750	750	695	720	720
200	675	750	750	655	600	620
300	655	720	730	640	540	560
400	635	695	705	620	495	515
500	600	665	665	585	465	480
600	550	605	605	535	435	450
650	535	590	590	525	430	445
700	535	570	570	520	425	430
750	505	530	530	475	415	425
800	410	510	510	390	405	420
850	270	485	485	270	395	420
900	170	450	450	170	390	415
950	105	320	375	105	380	385
1000	60	215	260	50	320	350
1050	—	145	175	—	305	345
1100	—	95	110	—	255	305
1150	—	60	70	—	200	235
1200	—	40	40	—	155	185

### CLASS 900

TEMPERATURE °F	Working pressure (psig)					
	WCB(1)	WC6(2)	WC9(2)	LCB(3)	CF8(4)	CF8M(4)
-20 to 100	2220	2250	2250	2085	2160	2160
200	2025	2250	2250	1970	1800	1860
300	1970	2165	2185	1915	1620	1680
400	1900	2080	2115	1850	1490	1540
500	1795	1995	1995	1745	1395	1435
600	1640	1815	1815	1600	1310	1355
650	1610	1765	1765	1570	1290	1330
700	1600	1705	1705	1555	1275	1305
750	1510	1595	1595	1420	1245	1280
800	1235	1525	1525	1175	1210	1265
850	805	1460	1460	805	1190	1255
900	515	1350	1350	515	1165	1245
950	310	955	1130	310	1145	1160
1000	155	650	780	155	965	1050
1050	—	430	525	—	925	1030
1100	—	290	330	—	770	915
1150	—	185	205	—	595	710
1200	—	115	125	—	465	555

### CLASS 2500

TEMPERATURE °F	Working pressure (psig)					
	WCB(1)	WC6(2)	WC9(2)	LCB(3)	CF8(4)	CF8M
-20 to 100	6170	6250	6250	5785	6000	6000
200	5625	6250	6250	5470	5000	5160
300	5470	6015	6070	5315	4500	4660
400	5280	5775	5880	5145	4140	4280
500	4990	5540	5540	4850	3880	3980
600	4560	5040	5040	4440	3640	3760
650	4475	4905	4905	4355	3580	3700
700	4440	4730	4730	4320	3540	3620
750	4200	4430	4430	3945	3460	3560
800	3430	4230	4230	3260	3360	3520
850	2230	4060	4060	2230	3300	3480
900	1430	3745	3745	1430	3240	3460
950	860	2655	3145	860	3180	3220
1000	430	1800	2170	430	2675	2915
1050	—	1200	1455	—	2570	2865
1100	—	800	915	—	2145	2545
1150	—	515	570	—	1655	1970
1200	—	315	345	—	1285	1545

(1) Not recommended for prolonged use above 800°F. (2) Not to be used over 1000°F. (3) Not to be used over 650°F.  
 (4) At temperature over 1000°F, use only when the carbon content is 0.04% or higher, they can be used to 1200-1500°F.

\*For weld end valves only. Flanged end ratings terminate at 1000°F.

NOTE: 1. Packing gasket or bolting may limit temperature. Please advise service temperature if above 1000°F.

2. Rating from ANSI B16.34 standard class valves.

3. Special class weld end valves to B16.34 are available on special order.

# SHARPE® VALVES

## FLANGE DIMENSIONS

### ANSI B16.5 RAISED FACE

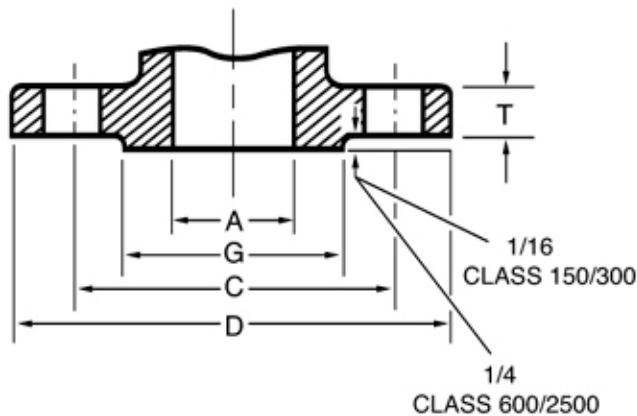

DIMENSIONS IN INCHES:

Class	Nominal Pipe Size	A	D	T	G	C	Stud Bolts		
							No.	Dia.	
Class 300	2	2.00	6.50	0.88	3.62	5.00	8	5/8	
	2 1/2	2.50	7.50	1.00	4.12	5.88	8	3/4	
	3	3.00	8.25	1.12	5.00	6.62	8	3/4	
	4	4.00	10.00	1.25	6.19	7.88	8	3/4	
	5	5.00	11.00	1.38	7.31	9.25	8	3/4	
	6	6.00	12.50	1.44	8.50	10.62	12	3/4	
	8	8.00	15.00	1.62	10.62	13.00	12	7/8	
	10	10.00	17.50	1.88	12.75	15.25	16	1	
	12	12.00	20.50	2.00	15.00	17.75	16	1 1/8	
	14	13.25	23.00	2.12	16.25	20.25	20	1 1/8	
	16	15.25	25.50	2.25	18.50	22.50	20	1 1/4	
	18	17.00	28.00	2.38	21.00	24.75	24	1 1/4	
	20	19.00	30.50	2.50	23.00	27.00	24	1 1/4	
	24	23.00	36.00	2.75	27.25	32.00	24	1 1/2	
30	29.00	43.00	3.62	33.75	39.25	28	1 3/4		
36	34.50	50.00	4.12	40.25	46.00	32	2		
Class 600	2	2.00	6.50	1.00	3.62	5.00	8	5/8	
	2 1/2	2.50	7.50	1.12	4.12	5.88	8	3/4	
	3	3.00	8.25	1.25	5.00	6.62	8	3/4	
	4	4.00	10.75	1.50	6.19	8.50	8	7/8	
	5	5.00	13.00	1.75	7.31	10.50	8	1	
	6	6.00	14.00	1.88	8.50	11.50	12	1	
	8	7.88	16.50	2.19	10.62	13.75	12	1 1/8	
	10	9.75	20.00	2.50	12.75	17.00	16	1 1/4	
	12	11.75	22.00	2.62	15.00	19.25	20	1 1/4	
	14	12.88	23.75	2.75	16.25	20.75	20	1 3/8	
	16	14.75	27.00	3.00	18.50	23.75	20	1 1/2	
	18	16.50	29.25	3.25	21.00	25.75	20	1 5/8	
	20	18.25	32.00	3.50	23.00	28.50	24	1 5/8	
	24	22.00	37.00	4.00	27.25	33.00	24	1 7/8	
30	27.37	44.50	4.50	33.75	40.25	28	2		
36	32.87	51.75	4.88	40.25	47.00	28	2 1/2		
Class 900	3	2.88	9.50	1.50	5.00	7.50	8	7/8	
	4	3.88	11.50	1.75	6.19	9.25	8	1 1/8	
	5	4.75	13.75	2.00	7.31	11.00	8	1 1/4	
	6	5.75	15.00	2.19	8.50	12.50	12	1 1/8	
	8	7.50	18.50	2.50	10.62	15.50	12	1 3/8	
	10	9.38	21.50	2.75	12.75	18.50	16	1 3/8	
	12	11.12	24.00	3.12	15.00	21.00	20	1 3/8	
	14	12.25	25.25	3.38	16.25	22.00	20	1 1/2	
	16	14.00	27.75	3.50	18.50	24.25	20	1 5/8	
	18	15.75	31.00	4.00	21.00	27.00	20	1 7/8	
	20	17.50	33.75	4.25	23.00	29.50	20	2	
	24	21.00	41.00	5.50	27.25	35.50	20	2 1/2	
	Class 1500	2	1.88	8.50	1.50	3.62	6.50	8	7/8
		2 1/2	2.25	9.62	1.62	4.12	7.50	8	1
3		2.75	10.50	1.88	5.00	8.00	8	1 1/8	
4		3.62	12.25	2.12	6.19	9.50	8	1 1/4	
5		4.38	14.75	2.88	7.31	11.50	8	1 1/2	
6		5.38	15.50	3.25	8.50	12.50	12	1 3/8	
8		7.00	19.00	3.62	10.62	15.50	12	1 5/8	
10		8.75	23.00	4.25	12.75	19.00	12	1 7/8	
12		10.38	26.50	4.88	15.00	22.50	16	2	
14		11.38	29.50	5.25	16.25	25.00	16	2 1/4	
16		13.00	32.50	5.75	18.50	27.75	16	2 1/2	
18		14.62	36.00	6.38	21.00	30.50	16	2 3/4	
20		16.38	38.75	7.00	23.00	32.75	16	3	
24		19.62	46.00	8.00	27.25	39.00	16	3 1/2	
Class 2500	2	1.50	9.25	2.00	3.62	6.75	8	1	
	2 1/2	1.88	10.50	2.25	4.12	7.75	8	1 1/8	
	3	2.25	12.00	2.62	5.00	9.00	8	1 1/4	
	4	2.88	14.00	3.00	6.19	10.75	8	1 1/2	
	5	3.62	16.50	3.62	7.31	12.75	8	1 3/4	
	6	4.38	19.00	4.25	8.50	14.50	8	2	
	8	5.75	21.75	5.00	10.62	17.25	12	2	
	10	7.25	26.50	6.50	12.75	21.75	12	2 1/2	
	12	8.62	30.00	7.25	15.00	24.38	12	2 3/4	

DIMENSIONS IN INCHES:

Class	Nominal Pipe Size	A	D	T	G	C	Stud Bolts	
							No.	Dia.
Class 150	2	2.00	6.00	0.75	3.62	4.75	4	5/8
	2 1/2	2.50	7.00	0.88	4.12	5.50	4	5/8
	3	3.00	7.50	0.94	5.00	6.00	4	5/8
	4	4.00	9.00	0.94	6.19	7.50	8	5/8
	5	5.00	10.00	0.94	7.31	8.50	8	3/4
	6	6.00	11.00	1.00	8.50	9.50	8	3/4
	8	8.00	13.50	1.12	10.62	11.75	8	3/4
	10	10.00	16.00	1.19	12.75	14.25	12	7/8
	12	12.00	19.00	1.25	15.00	17.00	12	7/8
	14	13.25	21.00	1.38	16.25	18.75	12	1
	16	15.25	23.50	1.44	18.50	21.25	16	1
	18	17.25	25.00	1.56	21.00	22.75	16	1 1/8
	20	19.25	27.50	1.69	23.00	25.00	20	1 1/8
	24	23.25	32.00	1.88	27.25	29.50	20	1 1/4
30	29.25	38.75	2.94	33.75	36.00	28	1 1/4	
36	35.00	46.00	3.56	40.25	42.75	32	1 1/2	

Due to continuous development of our product range we reserve the right to change the dimensions and information contained in the leaflet as required.

# SHARPE® VALVES

Choose from our full line of high quality valves and actuators to meet your needs.



## HOW TO ORDER

VALVE SIZE	VALVE SERIES	CLASS	ENDS	BODY MATERIAL	OPTIONS
1/2"	35 GATE	1-150#	1-FLANGE	4 - A-216 WCB	STANDARD STAINLESS VALVES CONTAIN PTFE GASKET AND GLAND PACKING
3/4"	45 GLOBE	3-300#	2-BUTT WELD	6 - A-351 316 SST.	CAST STEEL VALVES CONTAIN GRAFOIL GASKET AND GRAPHITE GLAND PACKING
1"	25 CHECK	6-600#		2 - ALLOY-20	
1-1/2"				1 - A-217 WC6	CALL SHARPE FOR OTHER MATERIAL
2"				3 - A-352 - LCB	
2-1/2"					
3"					
4"					
6"					
8"					
10"					
12"					
14"					
16"					
18"					
20"					
24"					

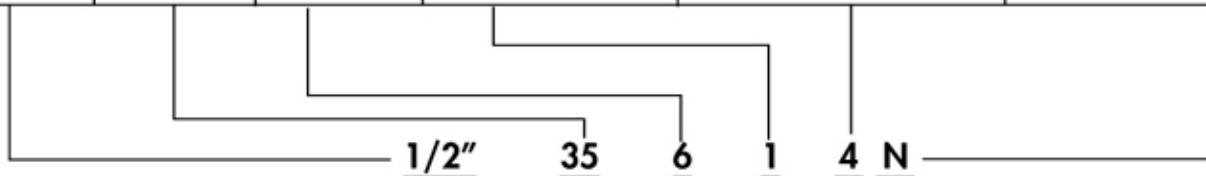

# SHARPE® VALVES

A Division of Smith-Cooper International, LLC

Toll Free: 1-877-7SHARPE  
(877) 774-2773

Fax: (708) 562-9250

Email: info@sharpevalves.com

www.sharpevalves.com

1260 Garnet Drive

Northlake, Illinois 60164 U.S.A.